



AL-KO ATC OWNER INSTRUCTION MANUAL

QUALITY FOR LIFE

CONTENTS

PAGE CONTENTS

1. GENERAL NOTICES
2. ATC APPLICATION & SAFETY INFORMATION
3. SYSTEM REQUIREMENTS & OPERATING INSTRUCTIONS
4. LED OPERATION
5. TROUBLESHOOTING, MAINTENANCE & WARRANTY
6. PUSH ROD REMOVAL

GENERAL NOTICES

READ AND ACT IN ACCORDANCE WITH THE FOLLOWING OPERATING INSTRUCTIONS BEFORE ATTEMPTING TO USE AL-KO ATC. THIS INSTRUCTION MANUAL SHOULD BE KEPT EITHER IN THE CAR OR CARAVAN AT ALL TIMES.

AL-KO ATC is a safety related product and, therefore, should only be fitted by an authorised AL-KO trained technician with experience of working with electrical installations.

Any evidence of removal or disassembly, other than by trained technicians, will immediately invalidate the product warranty.

AL-KO ATC TRAILER CONTROL SYSTEM

AL-KO ATC IS AN ELECTRONIC, EMERGENCY CONTROL SYSTEM FOR CARAVANS AND TRAILERS. IT AUTOMATICALLY RECOGNISES CRITICAL SWINGING MOTIONS AND APPLIES THE CARAVAN BRAKES ACCORDINGLY TO REGAIN CONTROL OF THE CARAVAN AND CAR.



SAFETY INFORMATION

AL-KO ATC IS A PASSIVE SAFETY PRODUCT THAT ACTIVATES THE BRAKING SYSTEM ON THE CARAVAN IN UNSAFE DRIVING CONDITIONS.

The driver has a responsibility under law to ensure that the elements of towing safety are met, including driving within the legal speed limit, consideration of road, weather and other traffic conditions, correct loading and coupling of the caravan.

AL-KO ATC is designed to fit only on AL-KO Chassis and is not suitable for non AL-KO Chassis.

AL-KO ATC only functions on caravans with a rigid towbar.

The electrical connection between the towing vehicle and caravan must be in good working order.

SYSTEM REQUIREMENTS

ATC draws power from the towing vehicle towbar and requires connection to either:

Twin 7-Pin Connection - ATC can be connected via the auxiliary 12S (white/grey) plug and requires power on requires power on Pins 4 (permanent supply) and 3 (earth). Please ensure that your vehicle towbar is correctly connected to ensure correct ATC operation. This can be checked with the use of a multimeter.

Important - A 20 amp fuse is required for the constant 12V supply to Pin 4 on the 12S socket. If only a single fuse is fitted to supply both Pins 4 and Pin 6, the power supply capability of the installation must be checked and a minimum fuse rating of 25 Amps must be used.

13 Pin Connection - ATC can be connected via the 13-Pin plug and requires power on Pins 9 (permanent supply) and 13 (earth). Please ensure that your vehicle towbar is correctly connected to ensure correct ATC operation. This can be checked with the use of a multimeter.

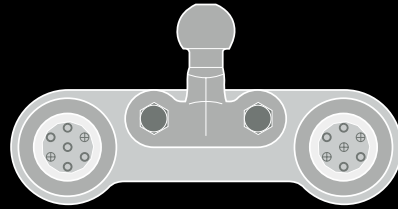

- | | | | |
|---|--|--|--|
| 1. Reversing light
(wire colour yellow) | | 5. Sensing Device
(not used) | |
| 2. Spare
(wire colour blue) | | 6. Fridge Supply
(wire colour red) | |
| 3. Earth
(wire colour white) | | 7. Fridge Earth
(wire colour black) | |
| 4. Auxiliary/Battery
(wire colour green) | | | |

OPERATING INSTRUCTIONS

After coupling the caravan correctly to the towing vehicle, connect the 12N & 12S plugs or the 13 Pin plug to the towbar.

Upon connection, ATC will carry out an initial self test and the LED light on the front fairing will light up RED. During the self test, the sound of the push rod moving inside ATC can be heard. When the self test is complete, the LED will turn GREEN or flashing GREEN to signal that ATC is active.

If the LED does not change to green, then ATC is not functioning correctly. The table provided on page 4 details what to do in this case.

Prior to commencing any journey, ensure that the caravan lighting is fully operational and check the vehicle is loaded appropriately, the nose weight and tyre pressures are correct, and confirm that the caravan is coupled to the vehicle with the breakaway cable correctly applied.

Always re-check the ATC LED is green after any interval during a journey, such as a service station break.



ATC LED on fairing

LED OPERATION

DISPLAY COLOUR	ATC CONDITION	DIAGNOSIS	WHAT TO DO	OUTCOME	STATUS
Green	ATC Active	Everything Ok			
Green Flashing	ATC Active	Self test incomplete	Drive forward to detect movement to complete self test and re check LED.	Green (Constant)	Ready for journey
Red	ATC Inactive	Possible to continue journey	Remove 12S or 13 Pin plug and wait 5 seconds. Reconnect plug.	Green Red	Ready for journey ATC Error logfile memory exceeded. Caravan can be towed, but ATC will not apply caravan brakes in the event of instability. See below*
Red flashing	ATC has detected a fault	Do not continue with ATC connected	Remove 12S or 13 Pin plug and wait 5 seconds. Reconnect the plug.	Green Red (flashing)	Ready for journey ATC faulty, and cannot be driven. Remove push-rod as shown on page 5. Consult AL-KO, see back page for details.
LED not working	ATC has no power LED faulty	Check push rod position as shown on page 5 before continuing journey.	Remove 12S or 13 Pin plug and wait 5 seconds. Reconnect the plug. Check for constant live - refer to system requirements.	Green LED not working	Ready for journey If power ok, check push rod position: Red line visible - do not drive vehicle. Red line not visible - possible to continue journey but consult AL-KO see back page for details.

* ATC stores operating errors in a logfile which over time will become full and will result in the solid red light appearing. This needs to be erased and can be done easily by connecting the caravan to a 12 volt supply for a period of 12 hours. The power required to carry out this function is minimal. Most occurrences of these errors are due to power supply problems to ATC which could be due to low voltage, or an intermittent power supply from the towbar.

TROUBLESHOOTING

Should you experience a fault with ATC, the LED light on the fairing will change colour. Therefore, refer to the table on page 4 and follow the instructions.

If no illumination of the LED is evident, refer to system requirements on page 3 and check towbar wiring for permanent supply.

In the unlikely event that you receive a red flashing LED light and disconnecting and re-connecting the power does not alleviate the problem, check the push rod position as detailed below.

Locate ATC on the axle and check the position of the push rod.

If no red line is visible, ATC is not active, and can be driven. However, we recommend that you contact AL-KO at the earliest convenience.

If the red line is visible on the push rod, as shown on the left, the caravan should not be moved.

The push rod needs to be removed to deactivate ATC. Using two 17mm spanners, the removal process is as shown opposite.

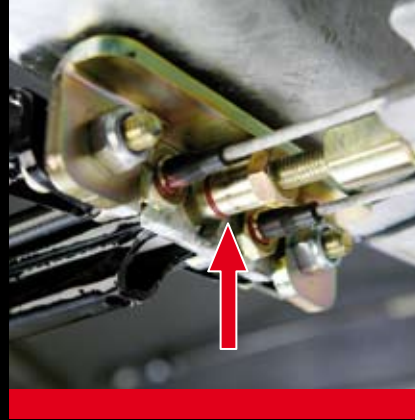

REMOVAL OF PUSH ROD:

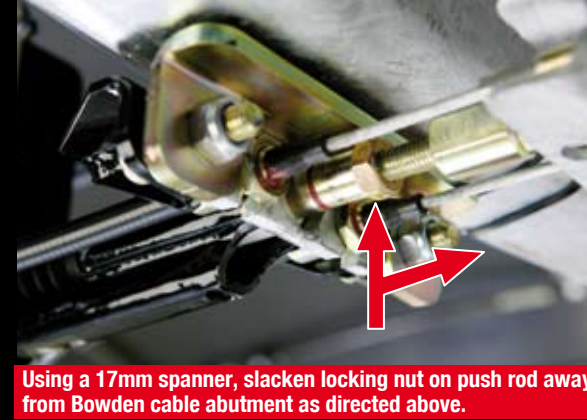

Using a 17mm spanner, slacken locking nut on push rod away from Bowden cable abutment as directed above.



Unscrew push rod from brake rod and slide it from the guide tube. Remove the locking nut from push rod using two 17mm spanners.

MAINTENANCE AND WARRANTY

ATC is maintenance free and requires no servicing. In case of any damage to ATC, please contact AL-KO. ATC is a sealed unit and any evidence of removal of ATC or the component parts including outer casing and fixings will immediately invalidate any product warranty.

ATC is covered by a 12 month warranty where it is retrofitted to a caravan. If ATC is fitted as standard by the vehicle manufacturer then ATC is covered for the same duration of the vehicle warranty or whichever is longer.

If ATC is subject to a call out under warranty and found to comply with the relevant specification or standard, then the cost of any testing or callout charges will be borne by the customer. We reserve the right to request credit card details to cover payment in advance.



Re-apply the removed locking nut onto brake rod thread to secure ball nut as shown above. ATC is now deactivated.

THE AL-KO FORMULA FOR OPTIMUM SAFETY.

THE AL-KO FORMULA FOR OPTIMUM SAFETY IS A COMBINATION OF INDUSTRY LEADING TECHNOLOGY THAT ENSURES THE SAFEST POSSIBLE DRIVING CONDITIONS FOR CARAVAN OWNERS. THE FORMULA PROVIDES TOTAL CONFIDENCE AND CONTROL WHEN TOWING A CARAVAN.



+



+



As an emergency system, AL-KO ATC automatically safeguards against a number of critical driving conditions. When used in conjunction with AL-KO AKS, there is no safer package for towing a caravan.

The AL-KO AKS Stabiliser device permanently suppresses small swinging and pitching movements in the trailer and increases the critical driving speed by approx 20%.

A safe driving style and correct loading combine with AL-KO technology to ensure optimum safety and unparalleled towing stability.

Visit www.al-ko.co.uk for more information on complementary products and our full range of caravan accessories.

QUALITY FOR LIFE

E-Mail: mail@al-ko.co.uk www.al-ko.co.uk Tel: 01926 818500

AL-KO Kober Ltd, South Warwickshire Business Park, Kineton Road, Southam, Warwickshire, CV47 0AL